

Anthony Martin

Estate Agents



Eversley Avenue, Bexleyheath

£1,095



Anthony Martin
Estate Agents

9 Midfield Parade, Mayplace Road East, Bexleyheath, Kent, DA7 6NB

01322 557457

barnehurst@anthonymartin.co.uk

www.anthonymartin.co.uk

Eversley Avenue, Bexleyheath

- First Floor Maisonette
- Bathrooms: 1
- Floor Area: 422 Sq Ft
- Great Size
- Rear Garden
- Bedrooms: 2
- Receptions: 1
- EPC: D 66
- Call Today
- New Carpets

Anthony Martin Estate Agents are delighted to offer you 'TO LET' This two bedroom maisonette on the popular 'ABC' roads in Barnehurst and is accessible to a range of amenities including transport links, parkland, schools, shops and more.

The accommodation comprises an Entrance Hall, a Lounge, a Kitchen with a range of matching wall and base units, a Double Bedroom, a Single Bedroom and a Family Bathroom. Externally the property boasts a southern facing Rear Garden. This property also benefits from being recently decorated and will have new carpets throughout.

Can Anthony Martin Estate Agents To Arrange Your Viewing!



Entrance Hall

Lounge/Diner

14'9 x 11'11 (4.50m x 3.63m)

Kitchen

6'3 x 6'0 (1.91m x 1.83m)

Bedroom 1

11'9 x 8'6 (3.58m x 2.59m)

Bedroom 2

8'4 x 6'1 (2.54m x 1.85m)

Bathroom

Outsdie

Rear Garden

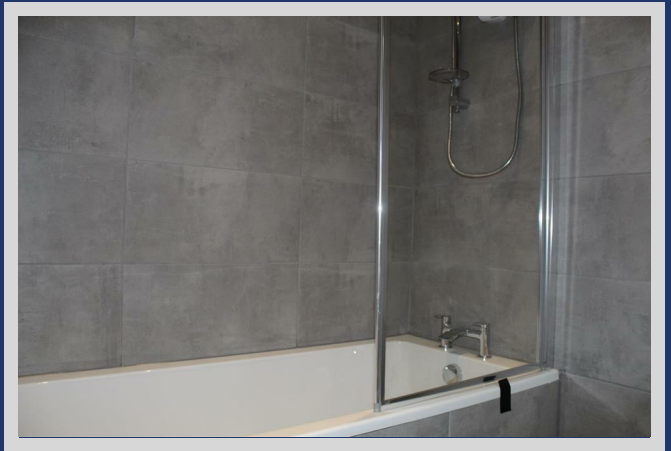
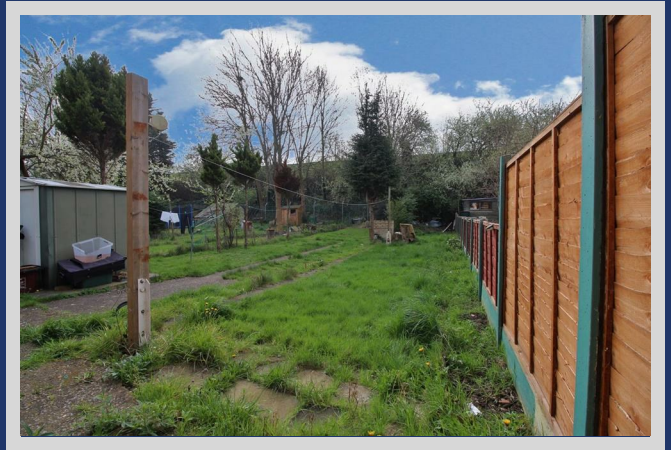

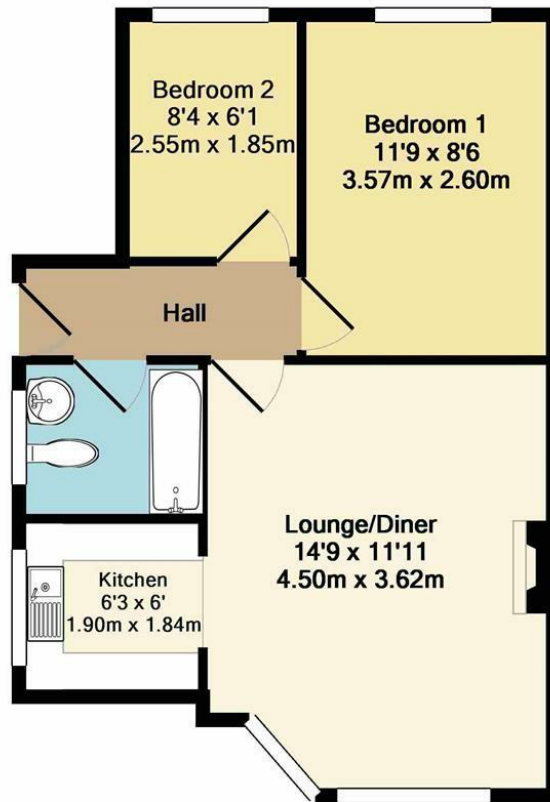

Total Approx. Floor Area 422 Sq.Ft. (39.2 Sq.M.)

Whilst every attempt has been made to ensure the accuracy of the floor plan contained here, measurements of doors, windows, rooms and any other items are approximate and no responsibility is taken for any error, omission, or mis-statement. This plan is for illustrative purposes only and should be used as such by any prospective purchaser. The services, systems and appliances shown have not been tested and no guarantee as to their operability or efficiency can be given

Made with Metropix ©2017



IMPORTANT: we would like to inform prospective purchasers that these sales particulars have been prepared as a general guide only. A detailed survey has not been carried out, nor the services, appliances and fittings tested. Room sizes should not be relied upon for furnishing purposes and are approximate. If floor plans are included, they are for guidance only and illustration purposes only and may not be to scale. If there are any important matters likely to affect your decision to buy, please contact us before viewing the property.