

GROUND FLOOR
APPROX. FLOOR
AREA 482 SQ.FT.
(44.8 SQ.M.)

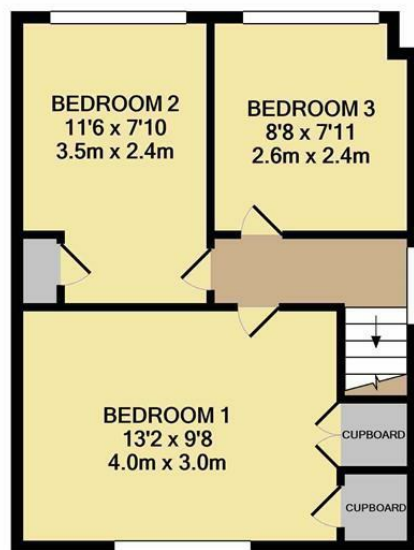

1ST FLOOR
APPROX. FLOOR
AREA 332 SQ.FT.
(30.8 SQ.M.)

TOTAL APPROX. FLOOR AREA 814 SQ.FT. (75.6 SQ.M.)

Whilst every attempt has been made to ensure the accuracy of the floor plan contained here, measurements of doors, windows, rooms and any other items are approximate and no responsibility is taken for any error, omission, or mis-statement. This plan is for illustrative purposes only and should be used as such by any prospective purchaser. The services, systems and appliances shown have not been tested and no guarantee as to their operability or efficiency can be given
Made with Metropix ©2020

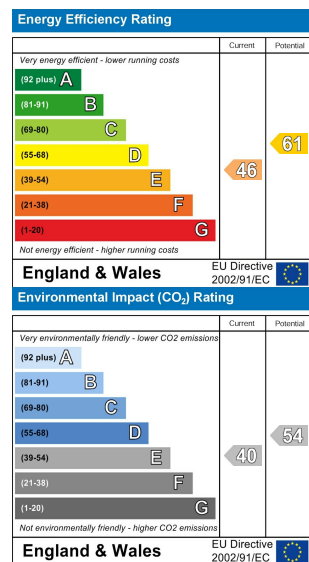

MAYPLACE AVENUE

DARTFORD

Offers Over £325,000



rightmove.co.uk
The UK's number one property website

Zoopa.co.uk

PrimeLocation.com

OnTheMarket.com

Anthony Martin
Estate Agents

Midfield Parade, 9 Mayplace Road East,
Bexleyheath, Kent, DA7 6NB

01322 557457

barnehurst@anthonymartin.co.uk

www.anthonymartin.co.uk

IMPORTANT: we would like to inform prospective purchasers that these sales particulars have been prepared as a general guide only. A detailed survey has not been carried out, nor the services, appliances and fittings tested. Room sizes should not be relied upon for furnishing purposes and are approximate. If floor plans are included, they are for guidance only and illustration purposes only and may not be to scale. If there are any important matters likely to affect your decision to buy, please contact us before viewing the property.

Anthony Martin
Estate Agents



Offers Over £325,000

CHAIN FREE PROPERTY.....

This well presented home offers excellent space with family sized accommodation as well as a south facing rear garden, on a popular road.

The accommodation comprises a, Entrance Hall , a modern-essential Ground Floor Bathroom, a spacious Lounge which has been made open plan onto a good sized kitchen to allow a great flow of space. To the rear patio doors which exudes natural light into the family home . The Kitchen comes equipped with matching wall and base units

The first floor comprises a light and airy Landing space, Boasting Three Good Sized Bedrooms.

Externally, this property benefits from a well maintained rear garden which, as you can see in the photos, The Front of the property boasts a pleasant front garden, as well as a good sized drive.

Viewings are Highly Recommended! Call Anthony Martin Estate Agents Today to book your viewing!

3 BEDROOMS • 1 RECEPTION ROOMS • 1 BATHROOMS

MAYPLACE AVENUE

DARTFORD

- Chain Free
- Semi Detached
- Down Stairs Bathroom
- South Facing Garden
- Off Road Parking
- 3 Good Sized Bedrooms
- Close to Haberdashers School
- Open Plan
- Desirable Location

