

Anthony Martin

Estate Agents



Egerton Close, Belvedere
£1,595



Anthony Martin
Estate Agents

9 Midfield Parade, Mayplace Road East, Bexleyheath, Kent, DA7 6NB

01322 557457

barnhurst@anthonymartin.co.uk

www.anthonymartin.co.uk

Egerton Close, Belvedere

- THREE BEDROOM HOUSE
- DOWNSTAIRS WC
- EPC - 84 B
- AVAILABLE NOW
- EN SUITE SHOWER ROOM
- CUL DE SAC
- 935 SQ FT
- CALL TODAY.

Anthony Martin Estate Agents are pleased to represent this 3 bedroom terraced house, Located in a quiet cul de sac and is a beautiful modern family home.

The ground floor consists of a large lounge to the rear, kitchen at the front and a downstairs WC.

Upstairs has a bathroom and three bedrooms, with one of them having an en suite shower room.

Please call us today to book your internal viewing on 01322 557 457 (opt 2)



ENTRANCE DOOR TO HALLWAY

WC

6 x 3'3 (1.83m x 0.99m)

KITCHEN/DINER

12'2 x 8'3 (3.71m x 2.51m)

LOUNGE

22 x 15'1 (6.71m x 4.60m)

1ST FLOOR LANDING

BEDROOM 1

13'1 x 8'8 (3.99m x 2.64m)

EN SUITE

8'8 x 4'2 (2.64m x 1.27m)

BEDROOM 2

10'3 x 8'8 (3.12m x 2.64m)

BEDROOM 3

8'10 x 6'4 (2.69m x 1.93m)

BATHROOM

7'11 x 6'4 (2.41m x 1.93m)





GROUND FLOOR
399 sq.ft. (37.1 sq.m.) approx.

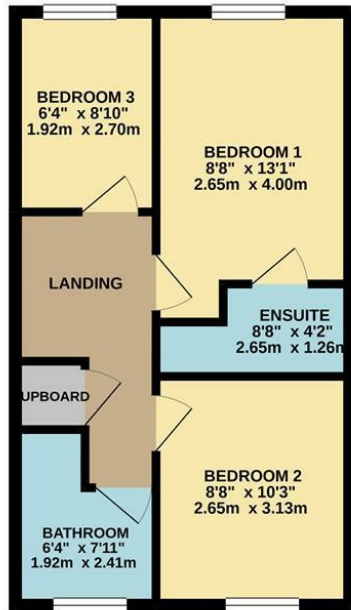

1ST FLOOR
536 sq.ft. (49.8 sq.m.) approx.

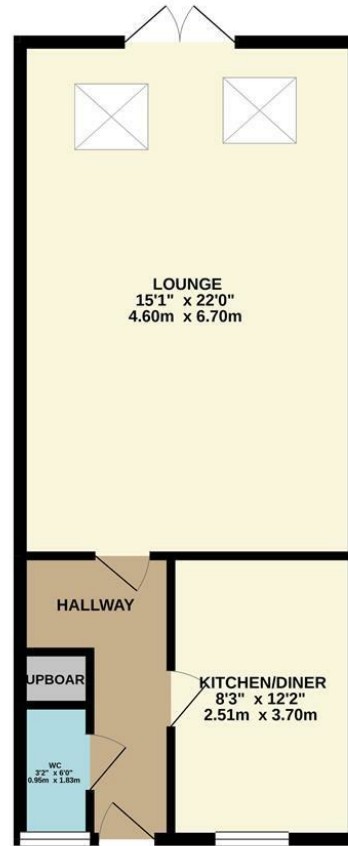

TOTAL FLOOR AREA : 935 sq.ft. (86.9 sq.m.) approx.

Whilst every attempt has been made to ensure the accuracy of the floorplan contained here, measurements of doors, windows, rooms and any other items are approximate and no responsibility is taken for any errors, omission or mis-statement. This plan is for illustrative purposes only and should be used as such by any prospective purchaser. The services, systems and appliances shown have not been tested and no guarantee as to their operability or efficiency can be given.
Made with Metropix ©2021