



SUMMERHOUSE DRIVE

BEXLEY

£1,250 PCM

Summerhouse Drive

BEXLEY

Anthony Martin Estate Agents are delighted to let this bungalow which Boasts 2 spacious double bedrooms as well as 2 reception rooms is located in the heart of Joydens Wood. This perfectly located semi-detached is convenient for the local shops and bus routes which are just a stone's throw away. As you enter this beautiful home, the entrance hall is a great size that leads onto a lounge which is open plan to a conservatory, the kitchen, two double bedrooms, one very spacious single bedroom, a bathroom and separate cloakroom. To the rear is a westerly facing and secluded low maintenance garden.

This homes biggest selling point has got to be the location, Joydens Wood is a quiet semi-rural area, perfect for a long term rental to call a family home. Joydens Woodland is on your doorstep, if you look around you will see the remains of the area's history, the banks, ditches, the remains of two late Iron Age roundhouses which are more than 2000 years old and the Faesten Dic, an Anglo-Saxon defensive bank and ditch running through the wood.

The local schools have always been very popular, Joydens Wood Infant and Junior School are just around the corner.

Available NOW To book an internal viewing please call 01322 47 99 33 (opt 2)

SUMMARY OF ACCOMMODATION

Bedroom

Bedroom

Bedroom

Kitchen

Living Room

Conservatory

Bathroom

W/C

Summerhouse Drive

BEXLEY

APPROX. GROSS INTERNAL FLOOR AREA sq ft

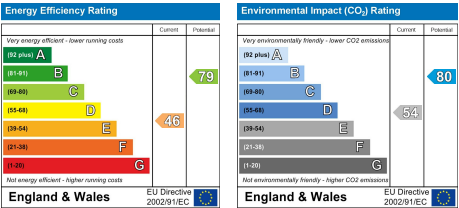
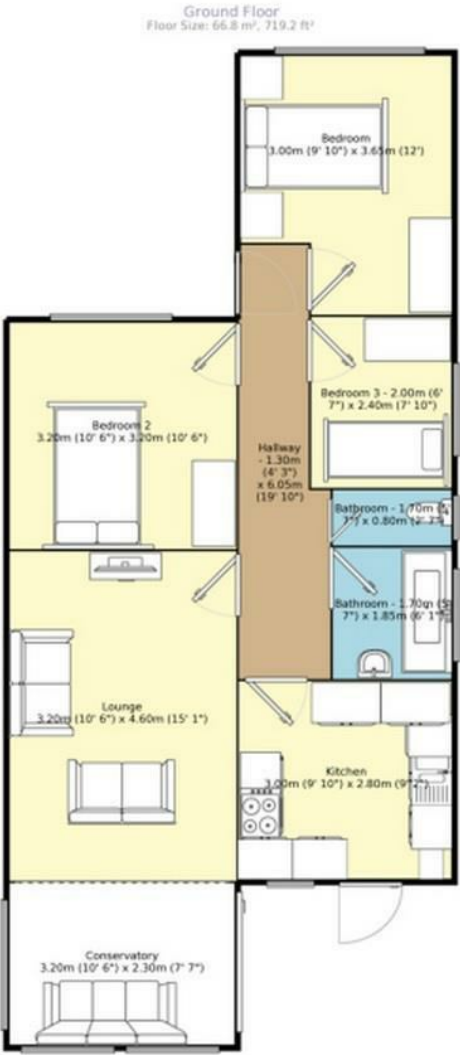

Summerhouse Drive

BEXLEY



7 Bourne Road, Bexley, DA5 1LW

01322 47 99 33

bexley@anthonymartin.co.uk

www.anthonymartin.co.uk www.rightmove.co.uk www.zoopla.co.uk www.primelocation.com