



## KESTREL PLACE, WATERSTONE PARK, GREENHITHE

£1,150

# Kestrel Place, Waterstone Way

WATERSTONE PARK, GREENHITHE

---

Anthony Martin Estate Agents welcome to the market this 2 bedroom first floor apartment. The abode benefits from an 19'65 x 11'33 open plan living space with the lounge/dining area open to a fitted kitchen, along with two double bedrooms and a contemporary en-suite shower room and bathroom. The property is fully double glazed and gas centrally heated throughout and has been recently refurbished throughout.

The River Thames, Greenhithe train station and Village are near, as too are Bluewater Shopping Centre and highly sought after Stone St Mary's Primary School. Dartford Crossing and the A2 are also close.

Call Anthony Martin estate agents now to view at your earliest convenience. EPC - B

## SUMMARY OF ACCOMMODATION

### **L-Shaped Entrance Hall**

16'78 x 10'66 x 3'92 (4.88m x 3.05m x 0.91m)

### **Open Plan Lounge/Diner/Kitchen**

19'65 x 11'33 (5.79m x 3.35m)

### **Balcony**

24'42 x 4'69 (7.32m x 1.22m)

### **Master Bedroom**

10'67 x 10'66 (3.05m x 3.05m)

### **En-Suite Shower Room**

6'85 x 4'93 (1.83m x 1.22m)

### **Bedroom Two**

11'59 x 7'7 (3.35m x 2.31m)

### **Bathroom**

7'39 x 6'88 (2.13m x 1.83m)

# Kestrel Place, Waterstone Way

WATERSTONE PARK, GREENHITHE

APPROX. GROSS INTERNAL FLOOR AREA 614.00 sq ft

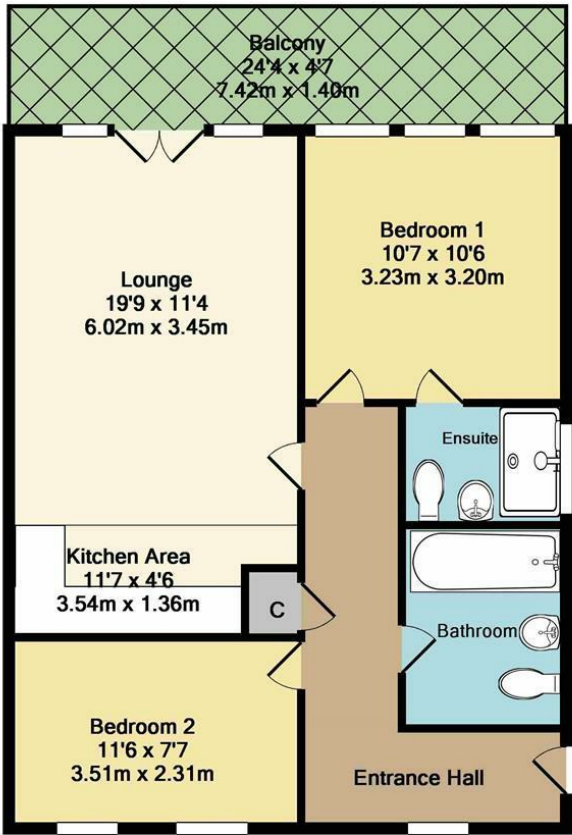

Total Approx. Floor Area 614 Sq.Ft. (57.0 Sq.M.)

Whilst every attempt has been made to ensure the accuracy of the floor plan contained here, measurements of doors, windows, rooms and any other items are approximate and no responsibility is taken for any error, omission, or mis-statement. This plan is for illustrative purposes only and should be used as such by any prospective purchaser. The services, systems and appliances shown have not been tested and no guarantee as to their operability or efficiency can be given  
Made with Metropix ©2017

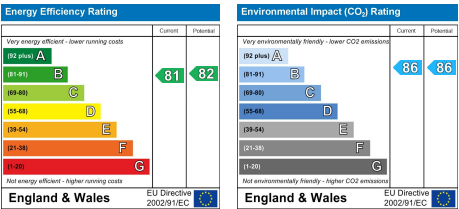

# Kestrel Place, Waterstone Way

WATERSTONE PARK, GREENHITHE

---



45 High Street, Swanscombe, Kent, DA10 0AG

[www.anthonymartin.co.uk](http://www.anthonymartin.co.uk) [www.rightmove.co.uk](http://www.rightmove.co.uk) [www.zoopla.co.uk](http://www.zoopla.co.uk) [www.primelocation.com](http://www.primelocation.com)

**01322 473355**

[swanscombe@anthonymartin.co.uk](mailto:swanscombe@anthonymartin.co.uk)