

GROUND FLOOR  
APPROX. FLOOR  
AREA 678 SQ.FT.  
(63.0 SQ.M.)

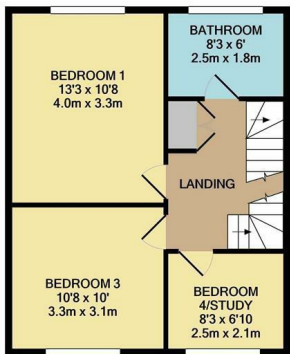

1ST FLOOR  
APPROX. FLOOR  
AREA 440 SQ.FT.  
(40.9 SQ.M.)

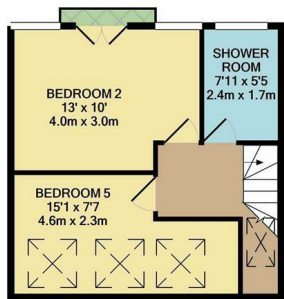

2ND FLOOR  
APPROX. FLOOR  
AREA 339 SQ.FT.  
(31.5 SQ.M.)

TOTAL APPROX. FLOOR AREA 1457 SQ.FT. (135.4 SQ.M.)  
Whilst every attempt has been made to ensure the accuracy of the floor plan contained here, measurements of doors, windows, rooms and any other items are approximate and no responsibility is taken for any error, omission, or mis-statement. This plan is for illustrative purposes only and should be used as such by any prospective purchaser. The services, systems and appliances shown have not been tested and no guarantee as to their operability or efficiency can be given.  
Made with Metropix ©2020



Energy Efficiency Rating		Current	Potential
Very energy efficient - lower running costs			
(92 plus)	A		
(81-91)	B		
(69-80)	C		
(55-68)	D		
(39-54)	E		
(21-38)	F		
(1-20)	G		
Not energy efficient - higher running costs			
England & Wales		EU Directive 2002/91/EC	
Environmental Impact (CO <sub>2</sub> ) Rating		Current	Potential
Very environmentally friendly - lower CO <sub>2</sub> emissions			
(92 plus)	A		
(81-91)	B		
(69-80)	C		
(55-68)	D		
(39-54)	E		
(21-38)	F		
(1-20)	G		
Not environmentally friendly - higher CO <sub>2</sub> emissions			
England & Wales		EU Directive 2002/91/EC	



BARNEHURST ROAD  
BEXLEYHEATH  
Guide Price £550,000



rightmove.co.uk  
The UK's number one property website

Zoopla.co.uk

PrimeLocation.com

onTheMarket.com

Anthony Martin  
Estate Agents

Midfield Parade, 9 Mayplace Road East,  
Bexleyheath, Kent, DA7 6NB

01322 557457  
barnehurst@anthonymartin.co.uk  
www.anthonymartin.co.uk

IMPORTANT: we would like to inform prospective purchasers that these sales particulars have been prepared as a general guide only. A detailed survey has not been carried out, nor the services, appliances and fittings tested. Room sizes should not be relied upon for furnishing purposes and are approximate. If floor plans are included, they are for guidance only and illustration purposes only and may not be to scale. If there are any important matters likely to affect your decision to buy, please contact us before viewing the property.

Anthony Martin  
Estate Agents



£550,000 - £575,000

Close to Barnehurst train station is this stunning five bedroom semi detached house. The property is well located for amenities, schools and further transport links making this an ideal home.

The ground floor is open plan and would suit those who like to entertain. There is a large entrance hall leading into an open plan living space incorporating the lounge and dining area together with a high spec kitchen. There are stunning views onto the garden. The open plan design and the granite topped island in the kitchen adds to the charm and any chef in the family could show off their skills in this great space. There is a dining area for the family to gather round with picturesque views onto the garden. The main reception room is at the front and flows nicely with the kitchen area, and with bi-fold doors, this space can be closed of for a quiet night in with the family. There is ground floor w/c with toilet and hand basin.

The first floor offers three good size bedrooms. The master has plenty of space for wardrobes and all have been decorated and modernised since the owners have moved in. The family bathroom is off the hallway. The second floor offers a further two bedrooms and a second bathroom.

Outside is the garden. A great space for the family to have BBQ's and there is a raised patio area with a seating area to kick back and relax in.

There is off street parking for three vehicles.

5 BEDROOMS • 1 RECEPTION ROOMS • 2 BATHROOMS

## BARNEHURST ROAD

BEXLEYHEATH

- Semi Detached Family Home
- Five Bedrooms
- Open Plan Kitchen/Breakfast Room
- Two Bathrooms And W/C
- Area: 1,457 Sq,Ft
- Off Street Parking For Three Vehicles
- Large Garden
- Stones Throw Away From Train Station
- Shops And Amenities Close By
- Ideal Family Home

